

019 INTERMEDIATE PIVOT 3/4" OFFSET

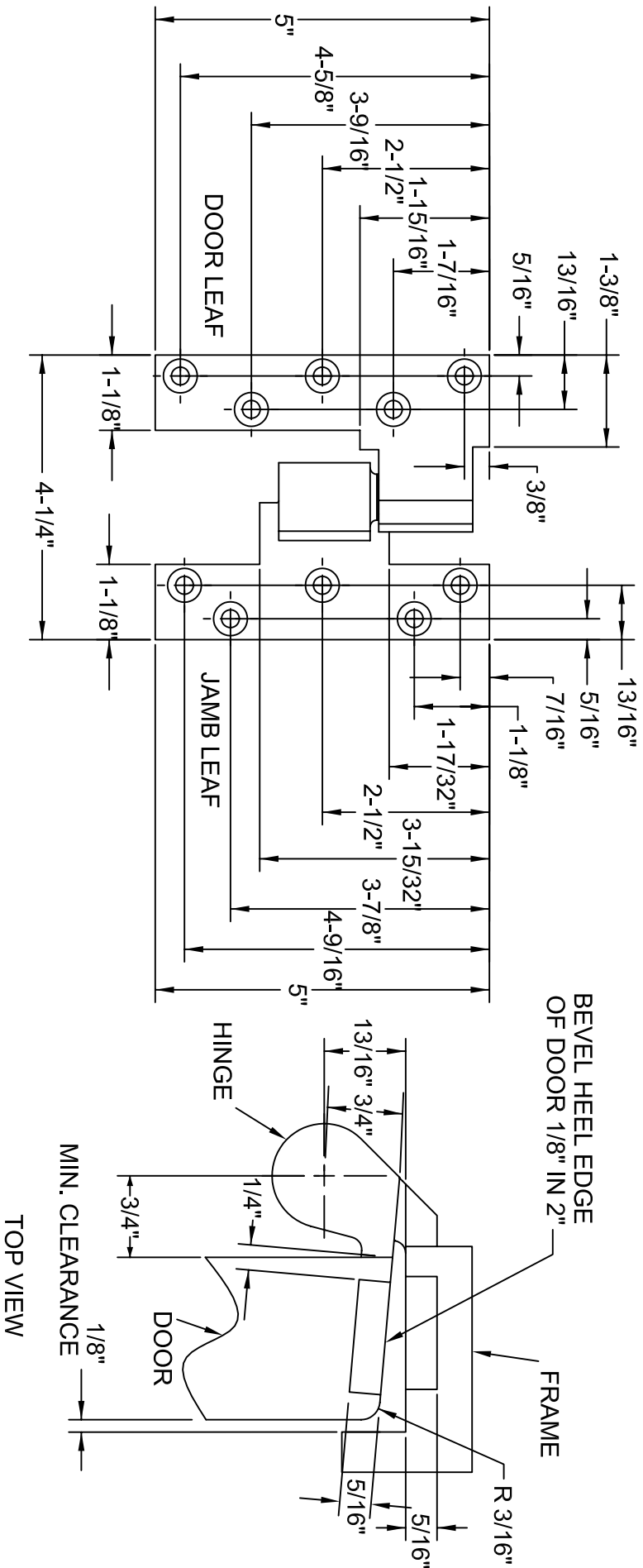

- NOTES:**
1. DO NOT SCALE DRAWINGS
 2. DIMENSIONS ARE GIVEN IN INCHES
 3. PIVOT DRILLED FOR 1/4" - 20 X 5/8" FHMS OR No. 14 X 1-1/2" FHWS.
 4. RIGHT HAND SHOWN

www.abhmfmg.com
 E-mail: abhinfo@abhmfmg.com
 Architectural Builders Hardware Mfg., Inc.
 1222 Ardmore Ave., Itasca, IL 60143
 630.875.9900; FAX 800.9FAXABH (932.9224)

ABH is a minority owned and operated manufacturing company.
 ©2004 ABH Mfg., Inc.
 printed in USA

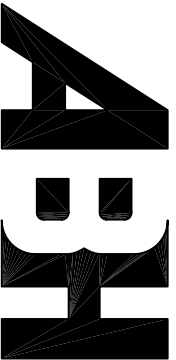

019 INTERMEDIATE PIVOT 3/4" OFFSET

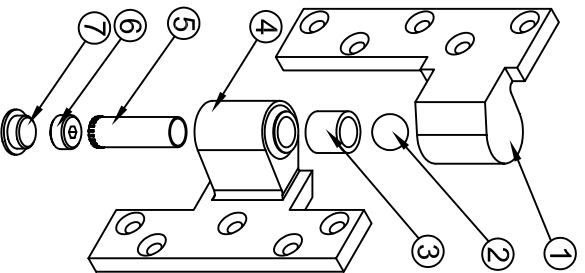

ITEM NO.	QTY.	PART NO.
1	1	019 Door Leaf
2	1	019 Alignment Ball
3	1	019 Needle Bearing
4	1	019 Jamb Leaf
5	1	019 Pivot Pin
6	1	019 Retainer Screw
7	1	019 End Cap

IF BOTTOM ARM IS FOR 0117 PIVOT,
MAKE SURE THE ARM IS SITTING
ALL THE WAY DOWN ON THE BASE.
MAKE NO ADJUSTMENT TO THE 019.

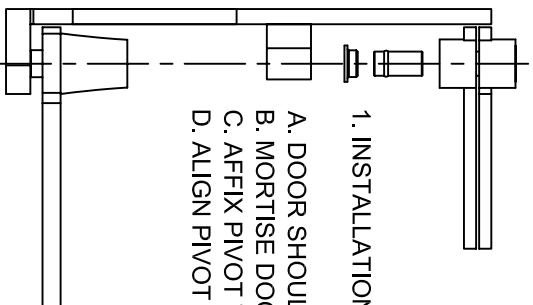
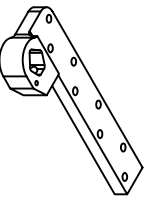

1. INSTALLATION INSTRUCTIONS
- DOOR SHOULD ALREADY BE HUNG W/ TOP PIVOT & BOTTOM PIVOT (OR FLOOR CLOSER).
 - MORTISE DOOR & FRAME PER TEMPLATE ON REVERSE SIDE.
 - AFFIX PIVOT TO DOOR & FRAME.
 - ALIGN PIVOT POINT FROM TOP PIVOT TO BOTTOM ARM. (SEE DIAGRAM)

E. REMOVE END CAP (ITEM #7)

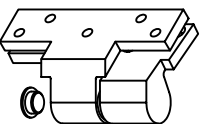

G. TURN RETAINER SCREW (ITEM #6)
COUNTERCLOCKWISE TO LOWER DOOR.

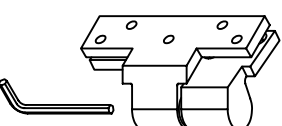

F. TURN RETAINER SCREW (ITEM #6)
CLOCKWISE. RAISE THE DOOR
TO THE DESIRED HEIGHT.

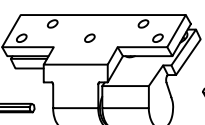

H. TIGHTEN RETAINER SCREW (ITEM #6)
UNTIL YOU FEEL RESISTENCE.
REPLACE END CAP (ITEM #7).

www.abhmfmg.com

E-mail: abhinfo@abhmfmg.com

Architectural Builders Hardware Mfg., Inc.

1222 Ardmore Ave., Itasca, IL 60143

630.875.9900; FAX 800.9FAXABH (932.9224)

©2007 ABH Mfg., Inc.
printed in USA

019-2-01.DWG

019

REVISED 05-21-07

ABH