

# CL200™ FlushHandle

The **CaviLock CL200** is a residential range of passage and privacy handles suitable for surface sliding and pocket doors (1-3/8" to 1-3/4" thick). When fitted to a pocket door, the CL200 allows the door to slide completely back inside the pocket, with the edge of the door finishing flush with the face of the pocket.

The front face plate on the CL200 incorporates a recessed edge-pull to allow the door to be withdrawn from the pocket when fully open. The CL200's deep recessed side pulls make even heavy doors easy to slide.



*Bi-Parting pocket doors with CL200 Passage handles in satin chrome.*



*A CaviLock CL200 Privacy handle in oil rubbed bronze.*

 **CaviLock®**

Handles & locks for sliding doors

# CL200™ FlushHandle

## Dimensions

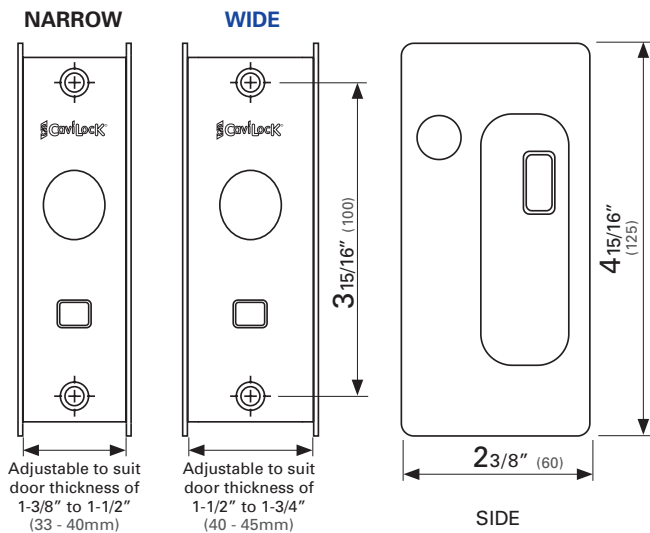
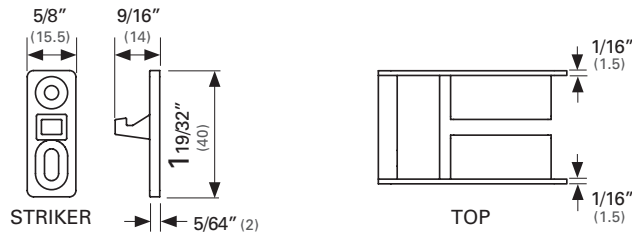

Two face plate widths are available. These are adjustable to suit doors from **1-3/8" to 1-1/2"** or **1-1/2" to 1-3/4"**.

The **CL200 Privacy** set is the latching version of the CL200. This is an ideal handle for sliding doors in **bathrooms** and **en suites, serveries**, and as a **latching handle for double doors**. It is not recommended for use in commercial situations. This handle does not comply with disabled egress requirements.

## Finish Options Wide Face Plate Available



**1210 / 1215** Oil Rubbed Bronze    **1090 / 1095** Satin Nickel    **1010 / 1015** Satin Chrome    **1020 / 1025** Chrome

**Other finish options available on request.**  
(Note: Longer lead times and additional surcharges may apply.)

## Configuration Options

### PRIVACY



**CONFIGURATION A**  
Privacy Snib Both Sides  
or  
Snib / Emergency  
(option when fitting)



**CONFIGURATION E**  
Passage with Striker  
For use only with Bi-Parting doors  
to match the Privacy A  
Configuration  
(Both Sides Blank)

### PASSAGE



**CONFIGURATION D**  
Passage - Both Sides Blank

### How to Specify (Privacy option)

**CL200 + Configuration (A or E) + Finish & Face Width**

E.g. CL200 Privacy with snib both sides, in satin chrome, with wide face plate would be specified as: **CL200A1015**

### How to Specify (Passage option)

**CL200 + Configuration (D) + Finish & Face Width**

E.g. CL200 Passage, blank on both sides, in satin chrome with wide face plate would be specified as: **CL200D1015**

Drawings & pictures are not to scale. All dimensions in inches (and mm).

[www.cavitysliders.com](http://www.cavitysliders.com)

High quality  
New Zealand made  
products



T (310) 890 8034  
(310) 890 6970  
F (310) 769 5824  
E [info@cavilock.com](mailto:info@cavilock.com)

**Cavity Sliders USA Inc.**

PO Box 1392  
Culver City  
CA 90232

Another quality product from:

**CavitySliders™**  
High Quality Sliding Door Hardware